

MY24 

NEW ENDURO BIKE LAUNCH



SHERCO

WATCH THE VIDEO





► INDEX

5 **ENDURO NEW RANGE**
7 **CYCLE PARTS IMPROVEMENTS**

125 SE **FACTORY**

250 I300 SE **FACTORY**

250 I300 SE **FACTORY**

21 **ENGINE IMPROVEMENTS**

250 I300 SE **FACTORY**

33 **450-500CC
IMPROVEMENTS**



SHERCO

ENDURO NEW RANGE

2T STROKE

125 SE

250
300 SE

4T STROKE

250
300 SEF

450
500 SEF



SHERCO

ENDURO
FACTORY

CYCLE PARTS IMPROVEMENTS

➤ NEW 2024 GRAPHICS KIT.



4T STROKE



2T STROKE

FULL RANGE

SHERCO

HEADLIGHT



- New Sherco visual identity, common to all models.
- New headlight housing with LED headlight.

FULL RANGE

SHERCO

FRONT FENDER



- New front fender design.
- Lighter and wider, provides improved protection from mud splashes.



FULL RANGE

SHERCO

FRONT BRAKE HOSE GUIDE



- New front brake hose guides (two instead of one).

FRAME



- New single color paint.
- More resistant to scratches and abrasions.

FULL RANGE

SHERCO

TRANSMISSION



- New aluminum rear sprocket.
- Weight reduction.

FULL RANGE

SHERCO



- New clutch cover.
- Weight reduction, improved clutch lubrication.



SPECIFIC IMPROVEMENTS



2T STROKE

25_{SE}

250
300_{SE}

4T STROKE

250
300_{SEF}

FRONT WHEEL



- New front wheel: rim, spokes, axle and hub.
- The hubs have been redesigned to improve rigidity, the weight has been reduced by 500 gr and the spacer system incorporates anti-mud flanges.

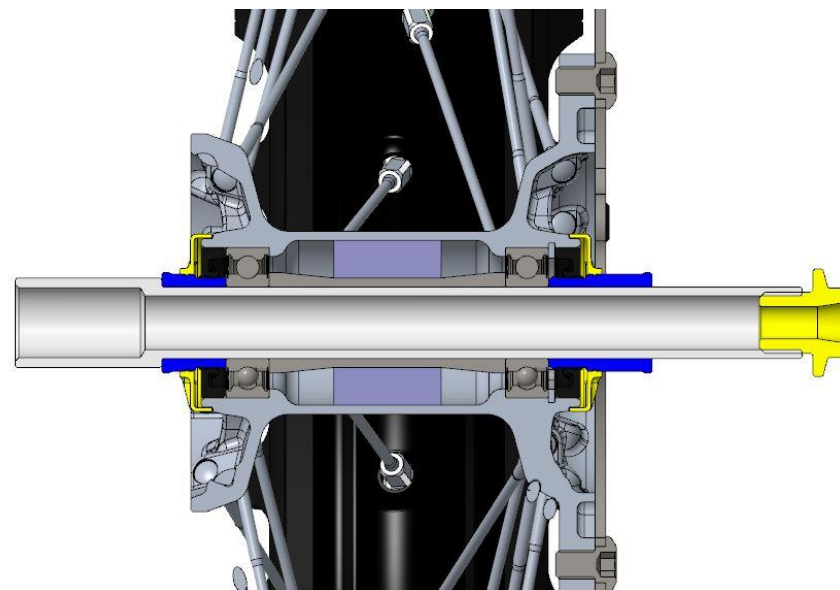

2T STROKE

125^{SE}250^{SE}300^{SE}

4T STROKE

250^{SEF}300^{SEF}

SHERCO

REAR WHEEL



- New rear wheel: rim, spokes, axle and hub.
- The hubs have been redesigned to improve rigidity, the weight has been reduced by 500 gr and the spacer system incorporates anti-mud flanges.

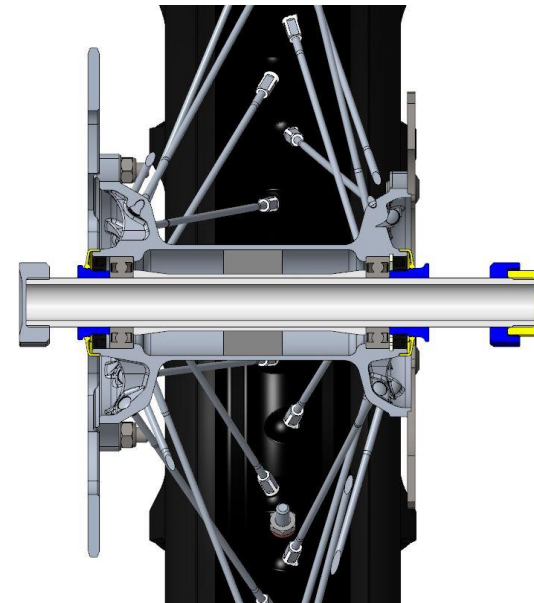

2T STROKE

125^{SE}

250

300^{SE}

4T STROKE

250

300^{SEF}

SHERCO

SWINGARM



- New design and new technology
- The weight has been reduced by 200 gr, the redesign provides improved riding comfort and traction, It also incorporates new bearings and seals. It is also designed to facilitate the adjustment of the chain tension, the chain tensioner system has 2 positions.



2T STROKE

125^{SE}250^{SE}
300^{SE}

4T STROKE

250^{SEF}
300^{SEF}

SHERCO

SPECIFIC IMPROVEMENTS



2T STROKE

25_{SE}

250
300_{SE}

CYLINDER HEAD BRACKETS



- New cylinder head support brackets.
- Reduced vibrations, better chassis rigidity, easier to assemble and disassemble, improved accessibility to the ignition coils.



2T STROKE

125^{SE}

250

300^{SE}

SHERCO

SPECIFIC IMPROVEMENTS

4T STROKE

250
300 SEF



ENGINE IMPROVEMENTS



➤ New engine.

4T STROKE

**250
300** **SEF**

CENTRAL CRANKCASES

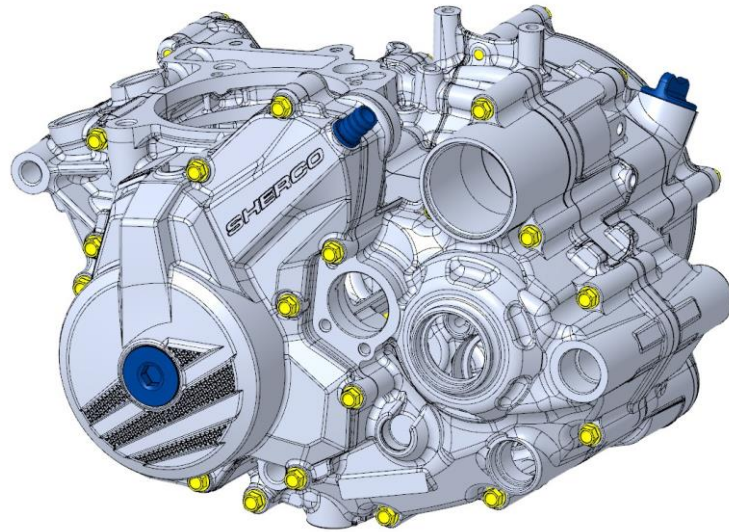

- **Lighter and more compact engine central crankcases.**
- **New liquid cooling layout: improve engine cooling in front area of crankshaft.**
- **New lower piston cooling piston oil jet (X2) to improved piston cooling.**

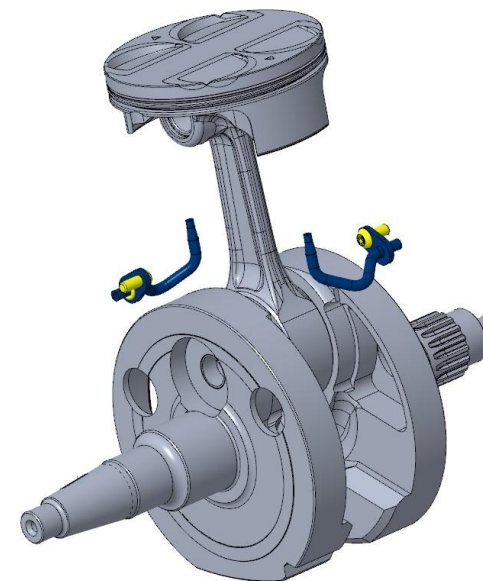
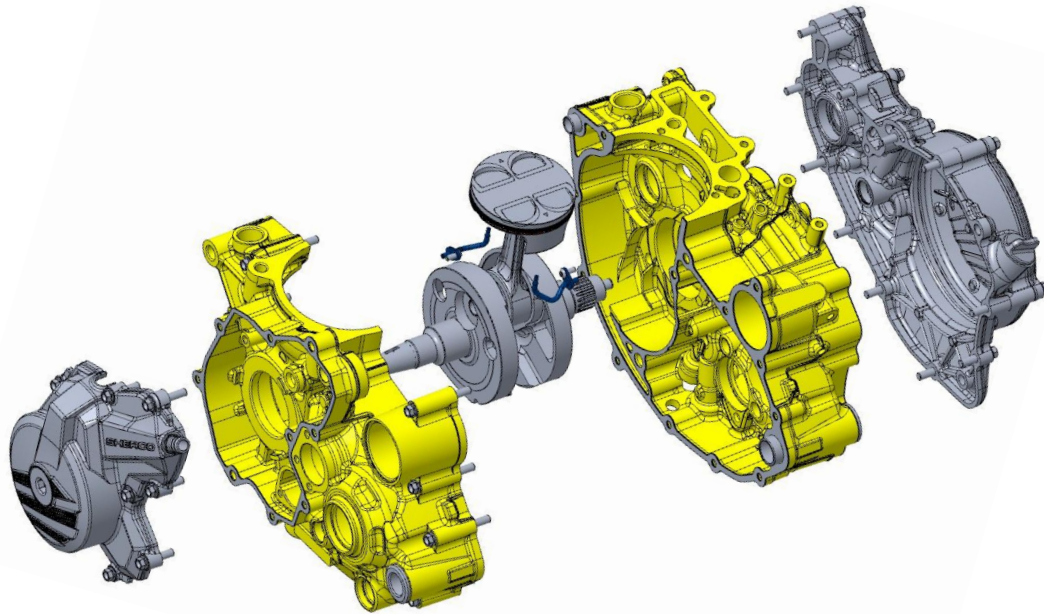

4T STROKE

**250
300** SEP**SHERCO**

CLUTCH COVER

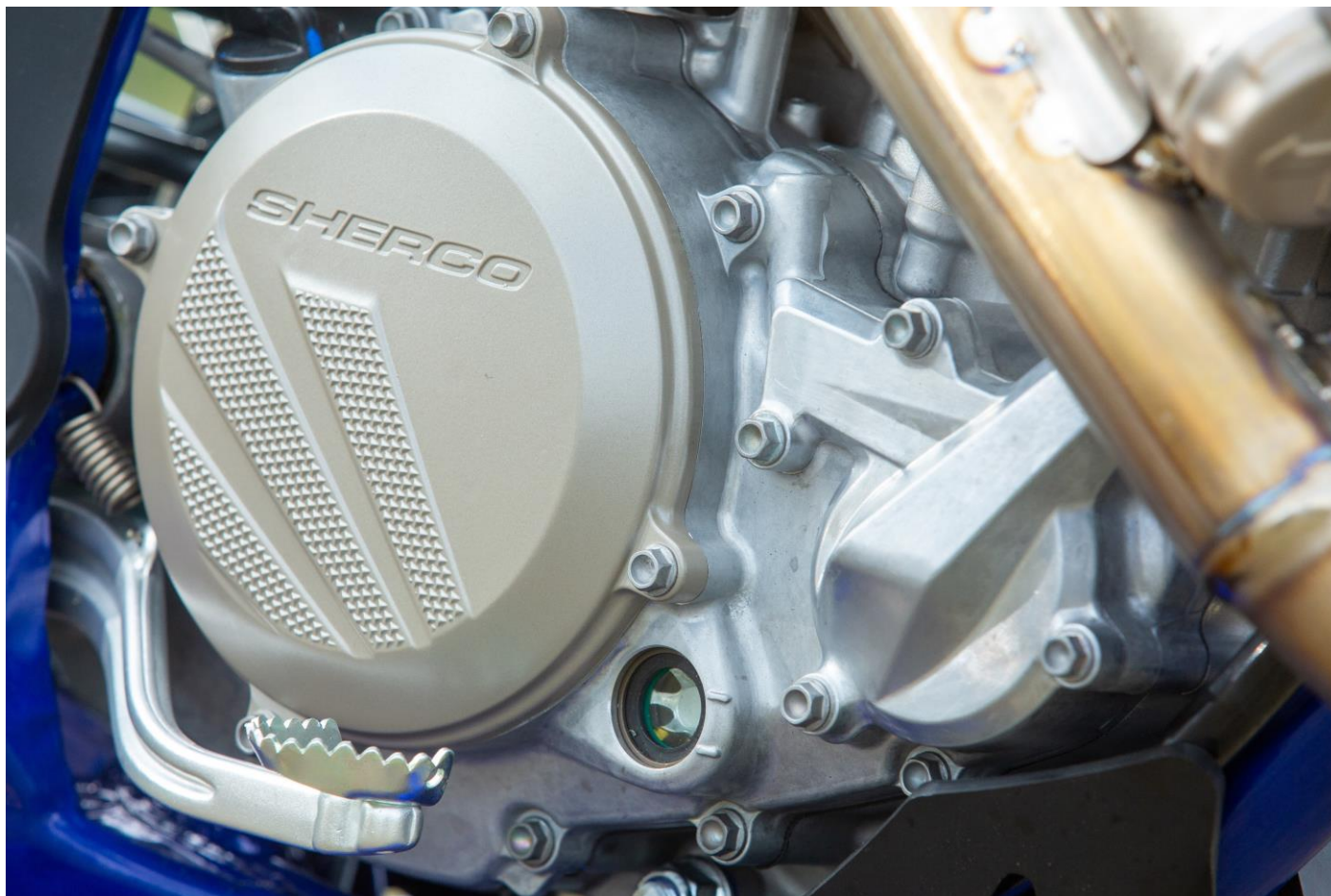

- New magnesium clutch cover.
- New visual identity and weight reduction.



4T STROKE

250
300 SEP

SHERCO

IGNITION COVER



- New magnesium ignition cover (weight reduction)
- New visual identity

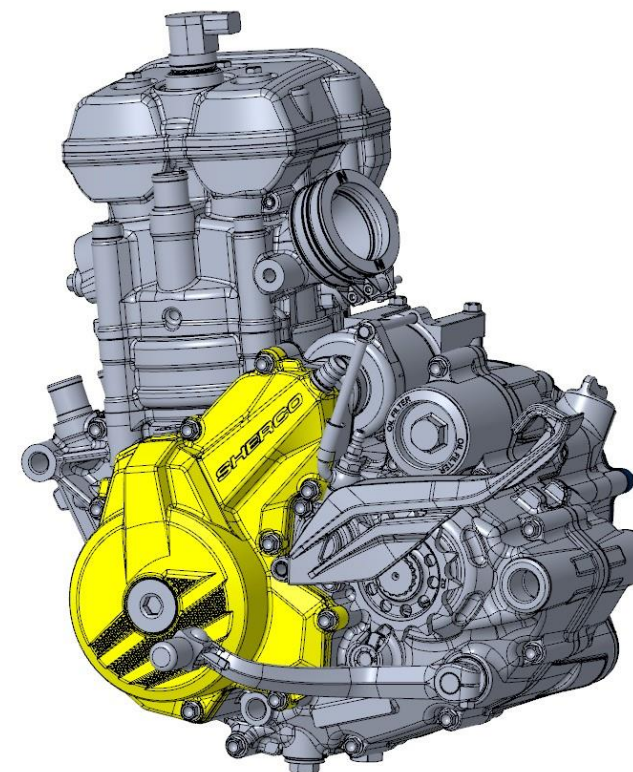

4T STROKE

250
300 SEF**SHERCO**

CLUTCH CASING

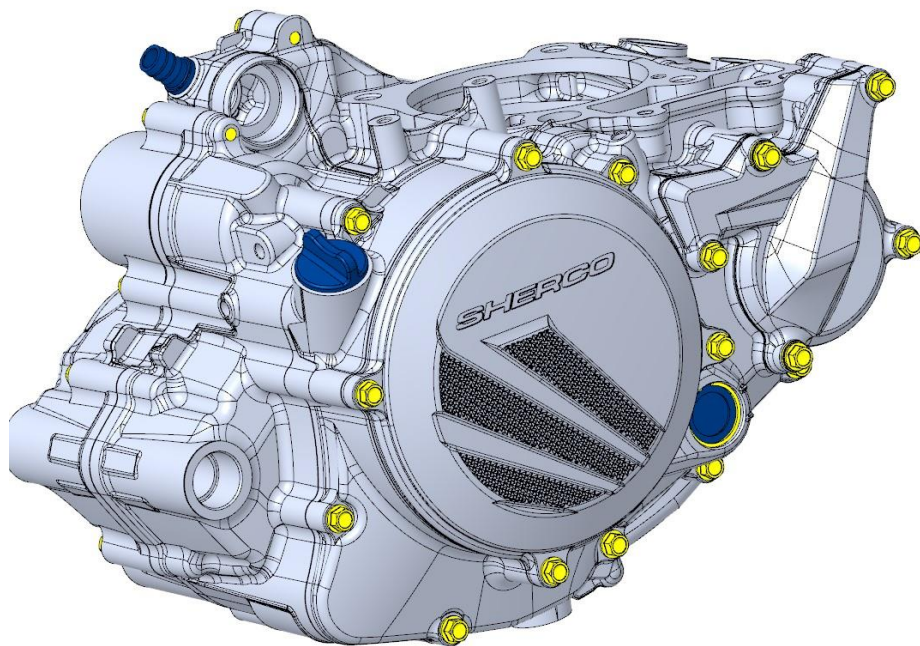

- New clutch casing.
- Repositioned oil level sight gage for ease of reading. Repositioned oil filler cap to provide easier filling.

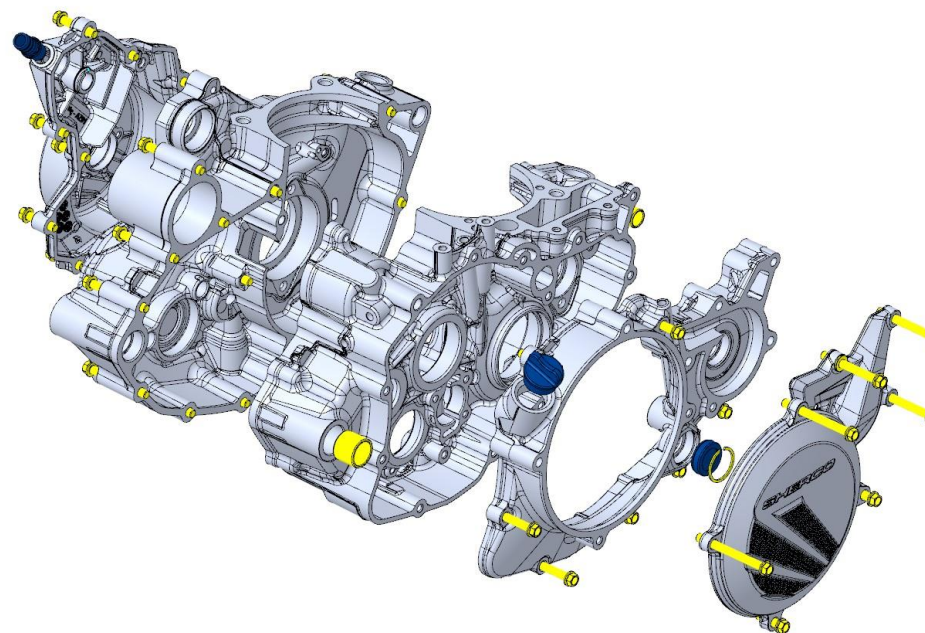

4T STROKE

**250
300** SEF**SHERCO**

ENGINE BALANCER

- New shaft and counterbalancer (integrated into the cam drive gear assembly).
- Weight reduction.

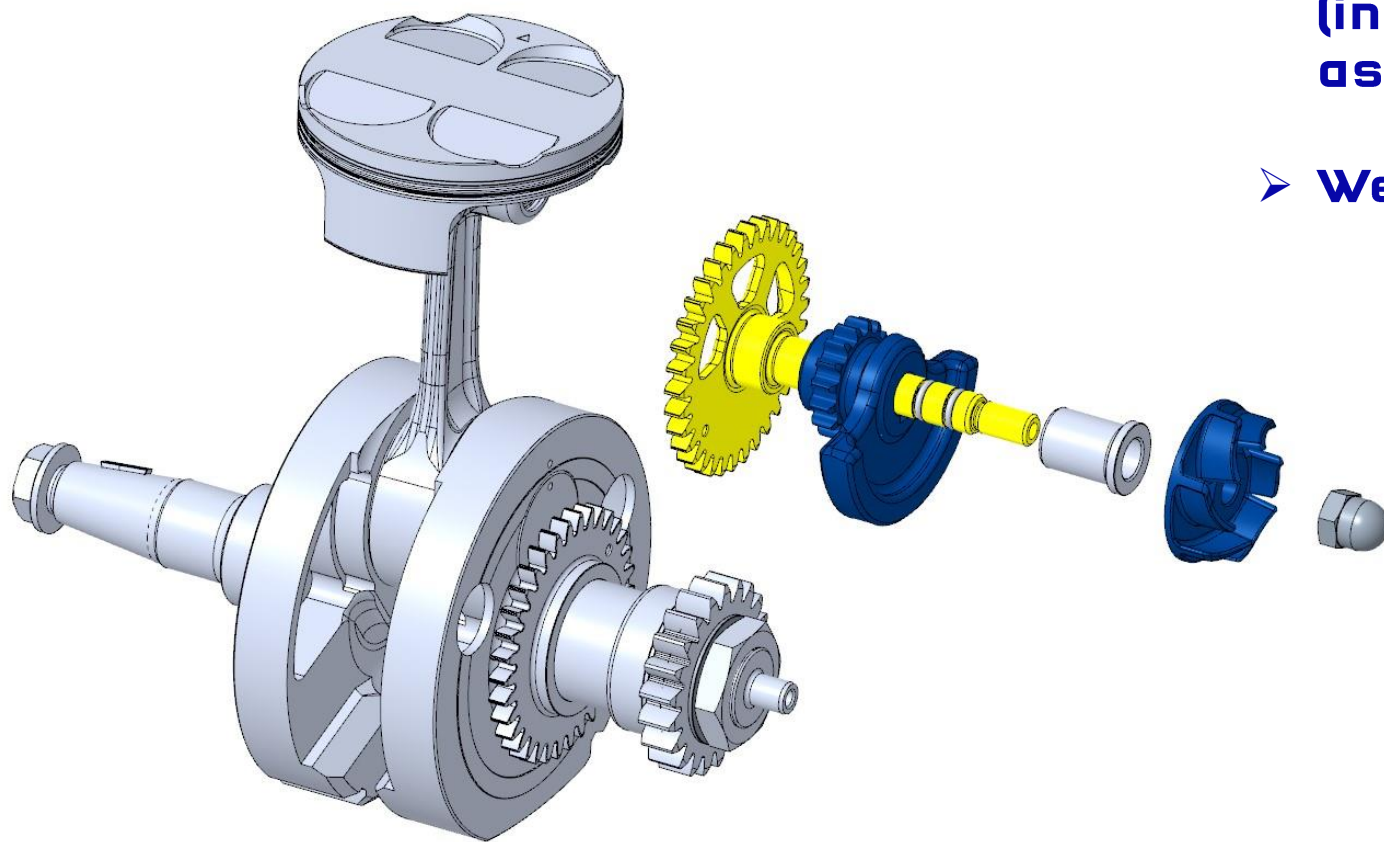

4T STROKE

250
300 SEF

SHERCO

CYLINDER HEAD 250^{SEP}

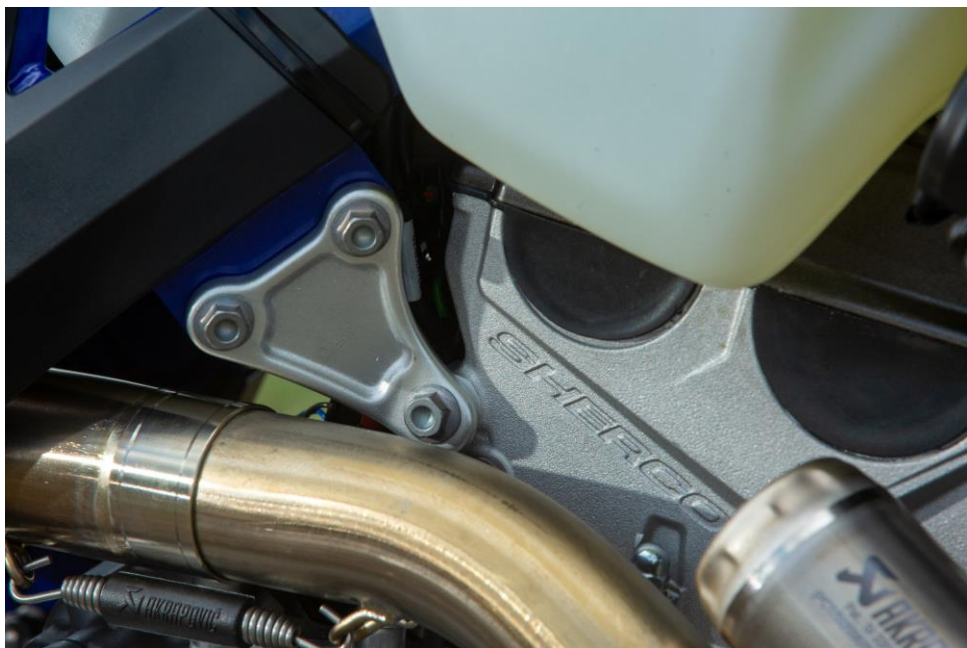

- New cylinder head with improved acoustics (internal ribs on the distribution side for noise reduction).
- New visual identity.
- New intake ports improving the volumetric efficiency at low revs. The redesigned exhaust ports allow a wide power band at the top end.

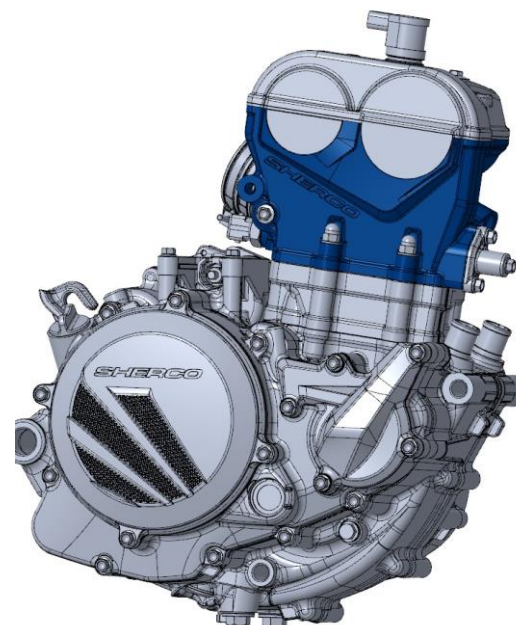
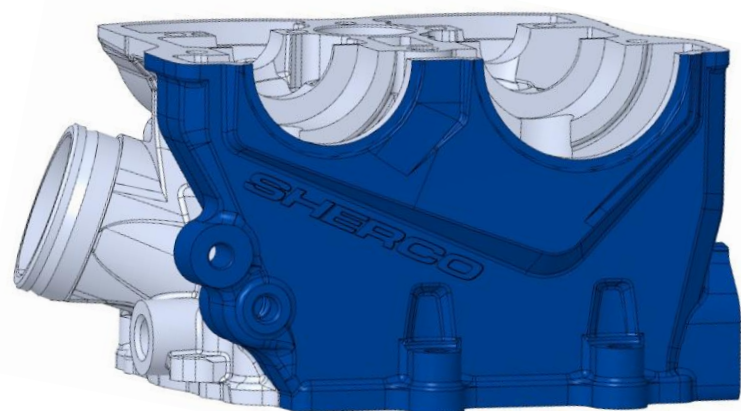

CYLINDER HEAD 300^{SEF}

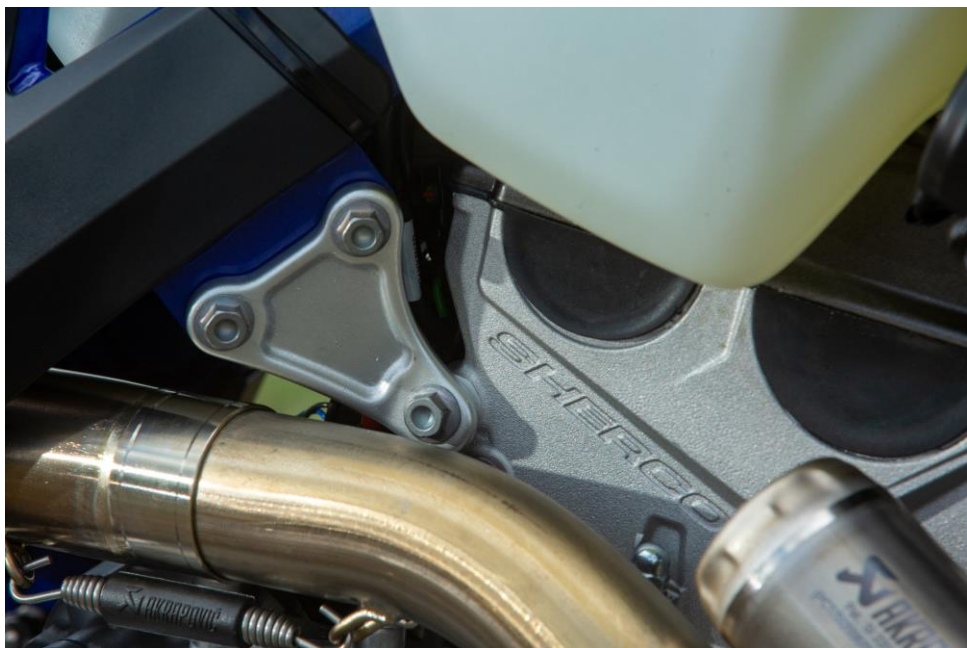

- New cylinder head with improved acoustics (internal ribs on the distribution side for noise reduction).
- New visual identity.
- New intake and exhaust ports.
- New intake ports improving the volumetric efficiency at low revs. The redesigned exhaust ports allow a wide power band at the top end.

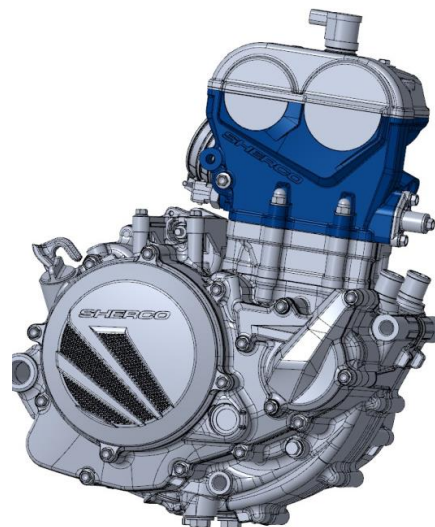
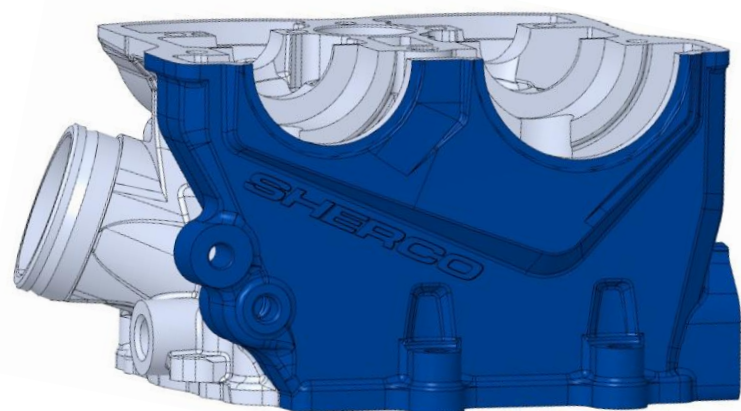

DISTRIBUTION

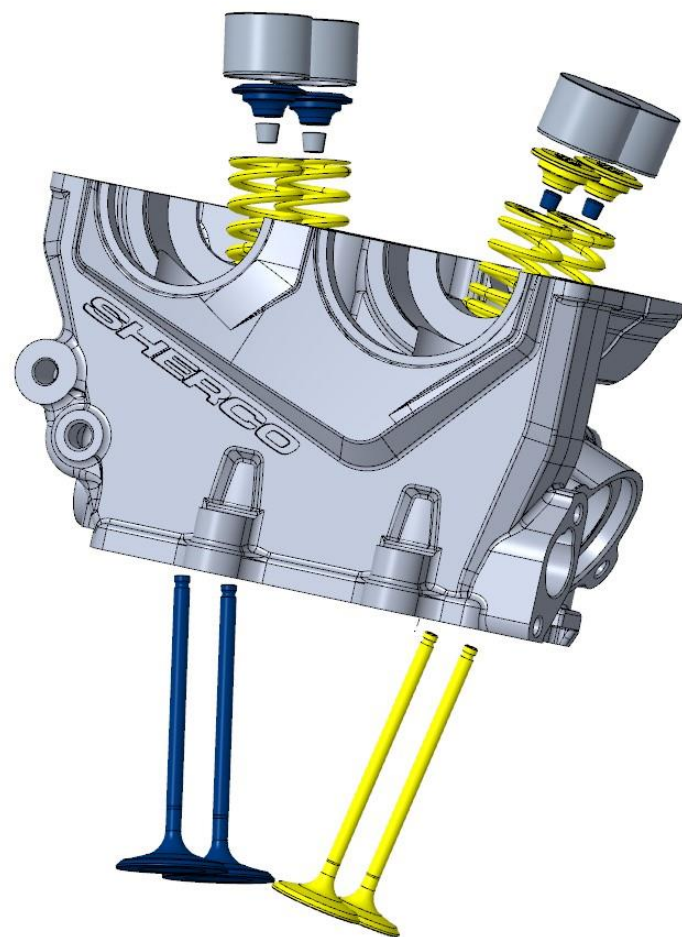

- New Titanium intake valves.
- New valve springs.
- The engine max RPM has been increased to 13,700 RPM. The engine is very linear and has an increased usable range.

4T STROKE

250
300 SEF**SHERCO**

LUBRIFICATION

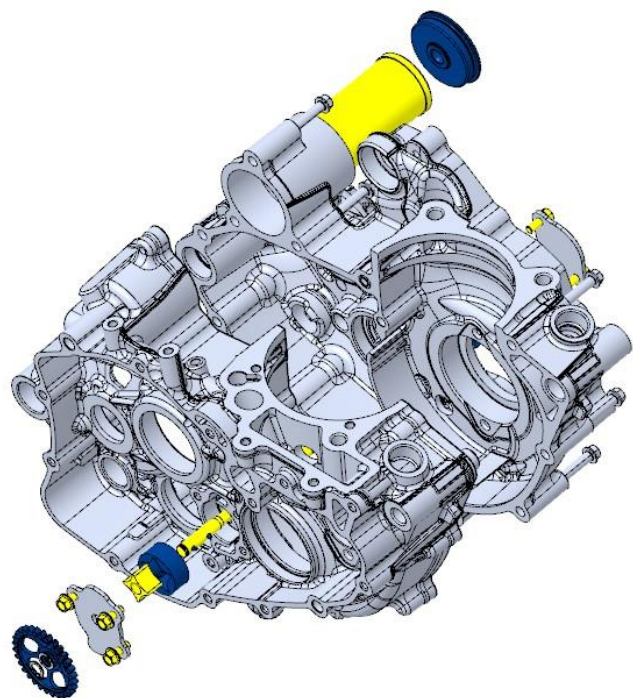

- New engine oil suction system (double suction pump) reduce all quantity in crankshaft area.
- Improved engine performance and significant reduction in engine braking.

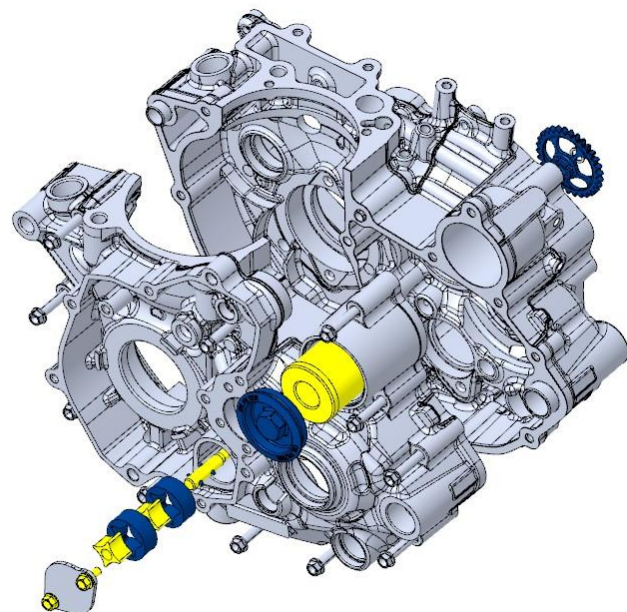

4T STROKE

250
300 SEF**SHERCO**

GEAR POSITION SENSOR

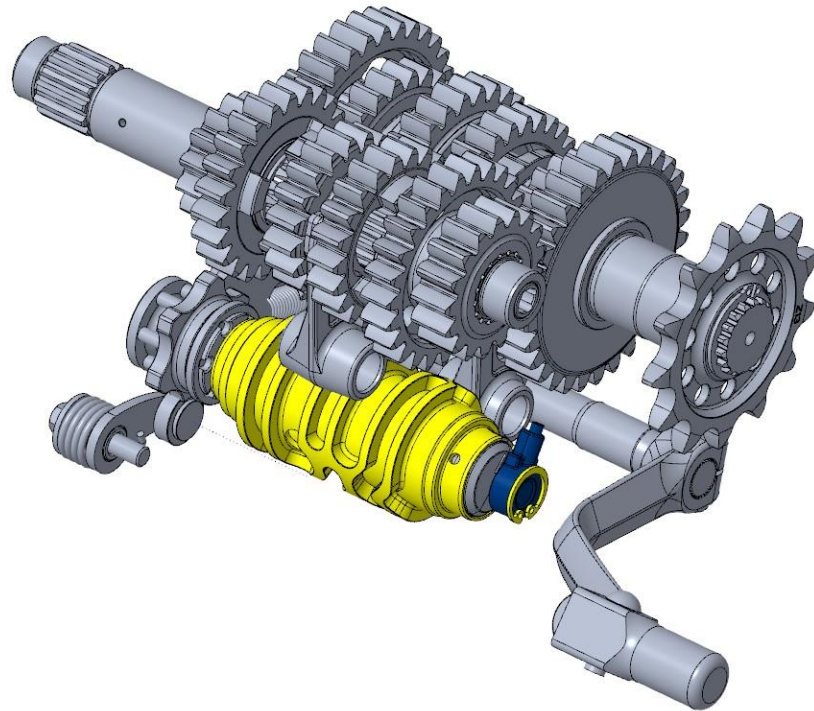

- Gear position sensor
- Allows the selection of a different MAP on each gear in order to have an optimal engine response in spite of a power gain.

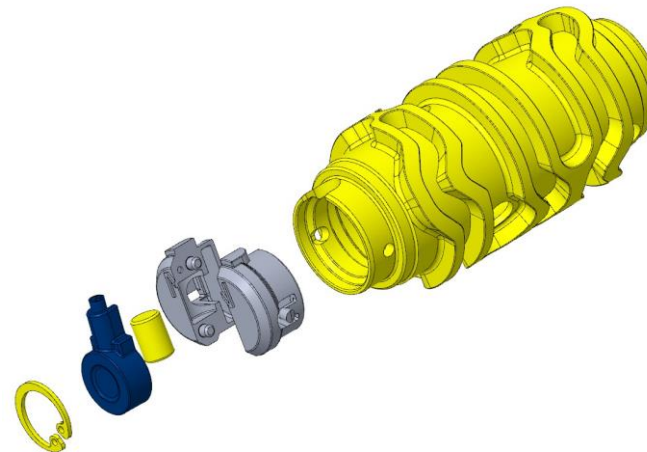

4T STROKE

250
300 SEF**SHERCO**

INJECTOR BODY

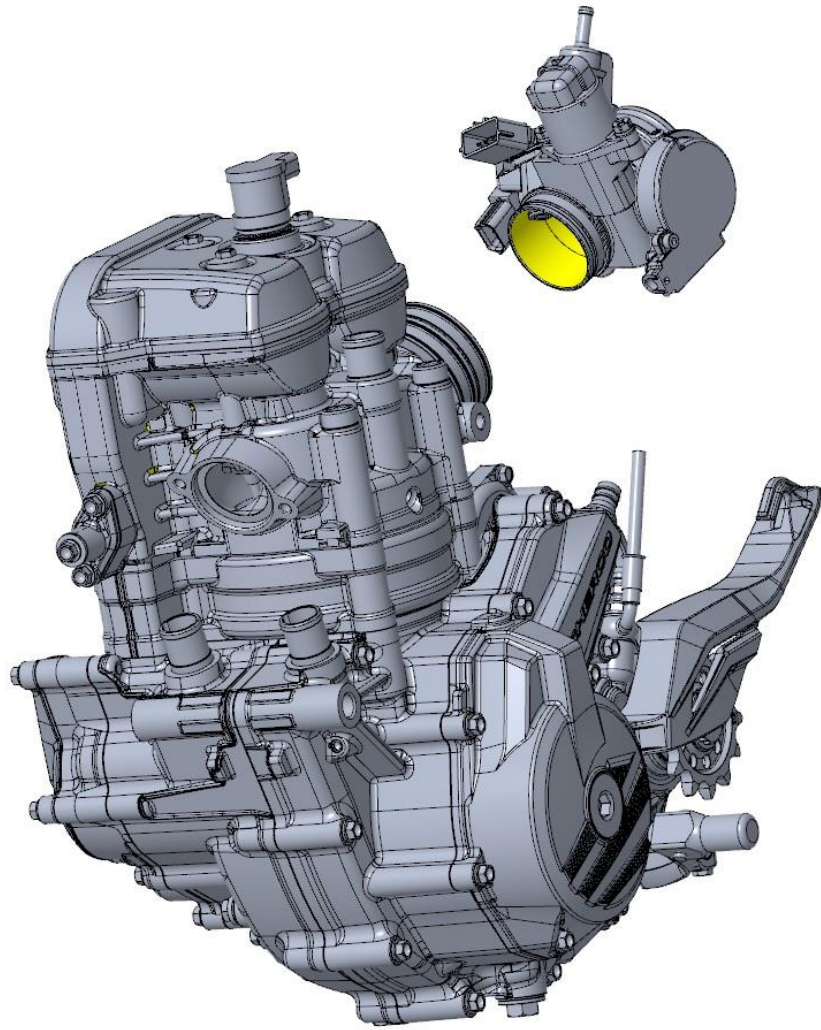

- Throttle body diameter increased from 38.5 mm to 42 mm.
- Increased power at high revs.

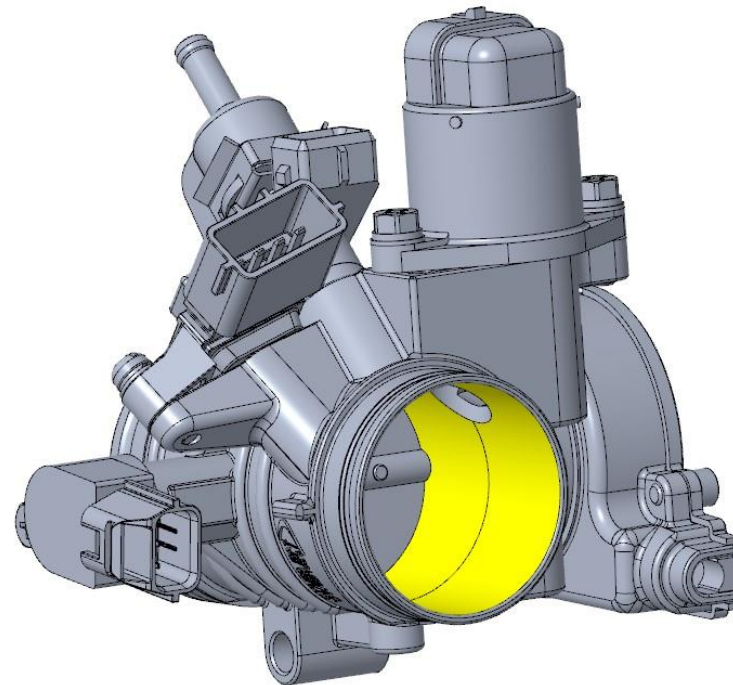

SPECIFIC IMPROVEMENTS

4T STROKE

450
500 SEF



IMPROVEMENTS



- 2024 graphics kit.
- Headlight.
- Front fender.
- Front brake hose guide.
- Frame color paint.
- Aluminum rear sprocket.
- Clutch cover.

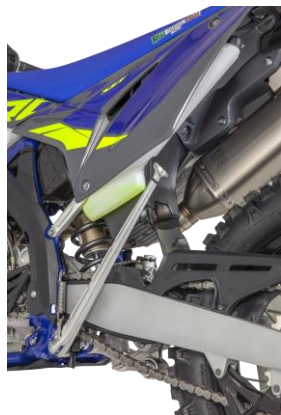

4T STROKE

450
500 SEF

SHERCO

SUMMARY

What is new ?	2 stroke		4 stroke				
	125 SE	250 SE	300 SE	250 SEF	300 SEF	450 SEF	500 SEF
2024 graphics kit	x	x	x	x	x	x	x
Headlight	x	x	x	x	x	x	x
Front fender	x	x	x	x	x	x	x
Front brake hose guides	x	x	x	x	x	x	x
Frame color paint	x	x	x	x	x	x	x
Aluminium rear spocket	x	x	x	x	x	x	x
Clutch cover with new design	x	x	x	x	x	x	x
Front wheel	x	x	x	x	x		
Rear wheel	x	x	x	x	x		
Swingarm	x	x	x	x	x		
Cylinder head brackets	x	x	x				
Full new engine				x	x		
Magnesium clutch cover				x	x		
Magnesium ignition cover				x	x		
Titane intake valves				x	x		

THE END



SHERCO.COM

SHERCO recommends **MOTUL**

SHERCO pictures, the company reserves the right, in order to improve its services, to change specifications and dimensions without prior notice. Pictures are not copy-written. There may be typographical errors in this literature. Pictures were taken abroad on private land. Photos © - J.M Pouget / M. Fant / MR. Sprang / F. Paul. Creation & réalisation

MGT

